

# 3SB3 Pushbutton Units and Indicator Lights, 22 mm

## Project planning aids

### Enclosures

#### Enclosure without protective collar, molded plastic

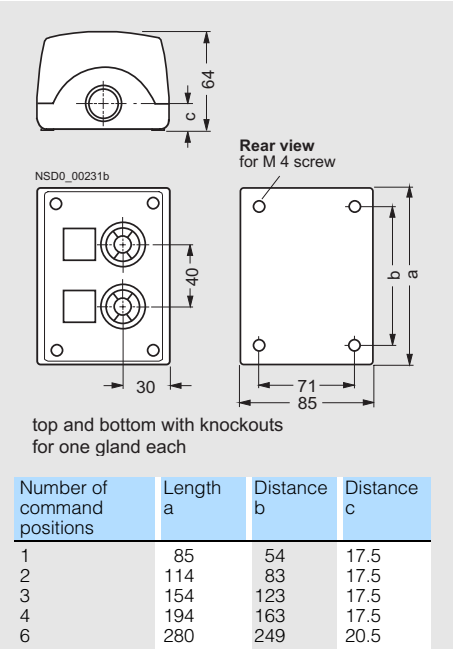

#### Enclosure without protective collar, metal

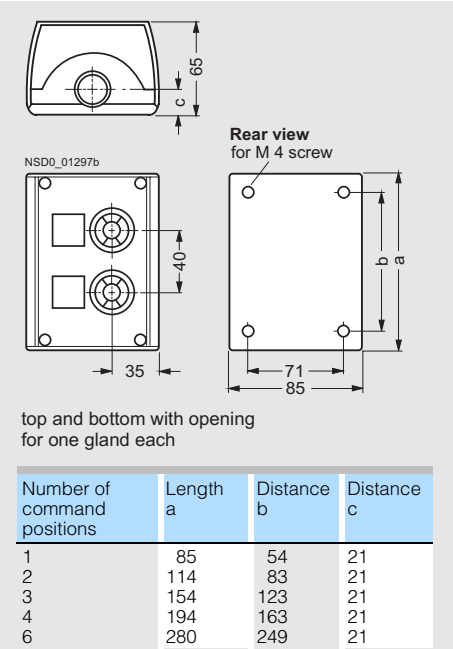

#### Enclosure with handle, metal

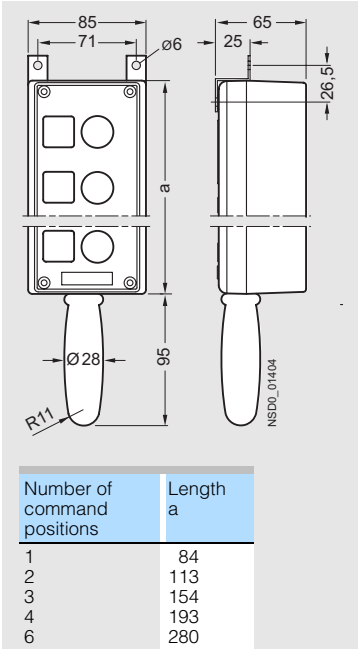

#### Enclosure with protective collar, molded plastic

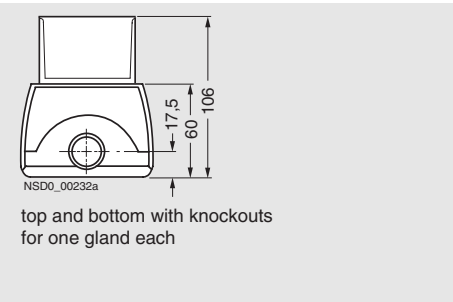

#### Enclosure with protective collar, metal

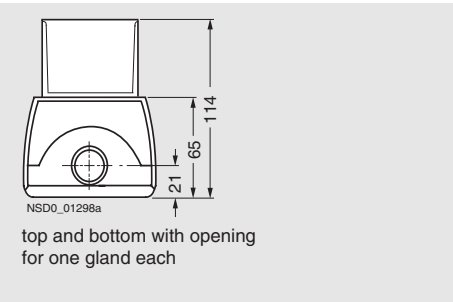

#### Enclosure with protective collar for 3 padlocks, metal

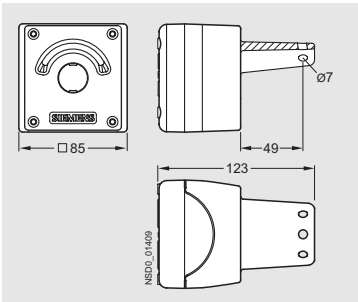

### Blocks with screw terminals, for floor mounting

#### Contact block with 1 contact

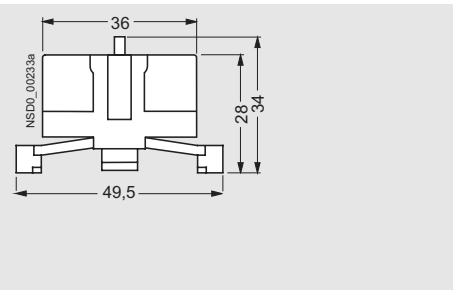

#### BA 9s lampholder without or with integrated voltage reducer

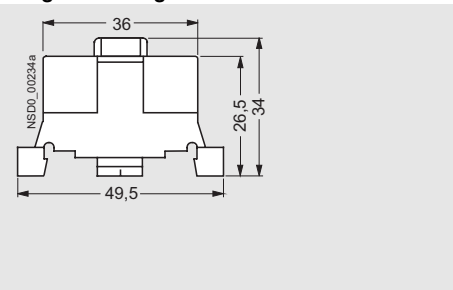

#### Lampholder with integrated LED

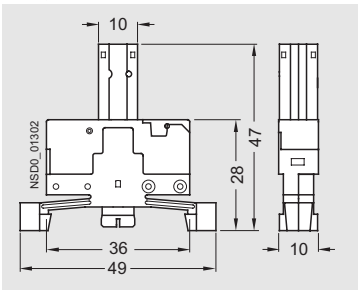

### Blocks with spring-loaded terminals, for floor mounting

#### Contact block with 1 contact

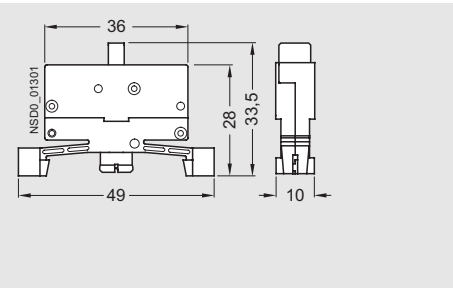

#### Lampholder with integrated LED

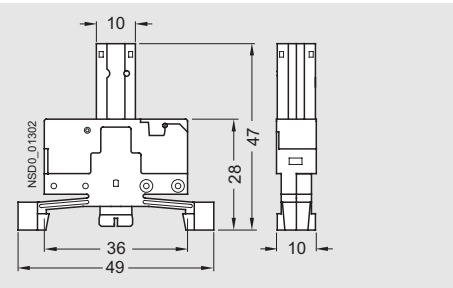

#### Fixpoint terminal

